

90° Copper Lug, AWG 2# , two hole 1/4", hole spacing 5/8", standard barrel, with inspection window,brown

- Copper cable lugs are designed for connecting copper cables, coils and Bus-bars
- Copper Tube Terminals between 6mm2 & 800mm2 have bell entry to ensure easy entry even for flexible conductors.
- Incorporates inspection window to check the correct cable positioning.
- The barrel length has been designed to allow easy and accurate positioning of the dies during the crimping operation.
- "colour code" help choose the right connector, the colour name is also printed in order to avoid problems for those who are colour-blind.

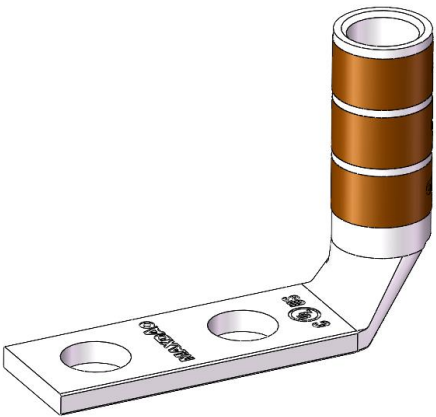

Product Classification

Item Number	6009725
Part Number	-
Detail Description	90°Copper Lug, AWG 2# , two hole 1/4", hole spacing 5/8", standard barrel, with inspection window,brown

General Specifications

Colour Code	Brown
Material	Copper
Tongue Type	Standard
Tongue Angle	90 degree
Surface	Tin-plated
Inspection Window	With inspection window

Dimensions

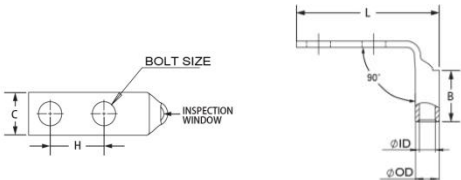

Bolt Size	1/4 in 6.9 mm
Hole Spacing (H)	5/8 in 16.0 mm
Tang Width (C)	0.60 in 15.2 mm
Barrel length (B)	0.88 in 22.4 mm

For more information, please visit:
www.maxdao.com



©Maxdao Inc. All rights reserved.
The information contained herein is subject to change without notice. We reserve the right to make technical changes or modify the contents of this document without prior notice.
Revised: Aug 30, 2024
Public

Overall length (L)	1.86 in 47.2mm
Inner diameter (ID)	0.31 in 7.9 mm
Outer diameter(OD)	0.42 in 10.7 mm

Electrical Specifications

Rating - Maximum Voltage	35KV
--------------------------	------

Environmental Specifications

Operating Temperature	-40 °C to +90°C (-40 °F to +212 °F)
Storage Temperature	-40 °C to +80 °C (-40 °F to +176 °F)

Packaging and Weights

Included	Lug
Packaging Quantity and UOM	1 pcs
Piece Weight	0.044 lb 0.02 kg

Certifications and Compliance

ISO 9001:2015	Designed, manufactured and/or distributed under this quality management system
RoHS	Compliant
UL	Compliant

