

Copper Lug, AWG2/0#, one hole 5/16", with inspection window,Narrow,Black

- Copper cable lugs are designed for connecting copper cables, coils and Bus-bars.
- Copper Tube Terminals between 6mm² & 800mm² have bell entry to ensure easy entry even for flexible conductors.
- Incorporates inspection window to check the correct cable positioning.
- "colour code" help choose the right connector, the colour name is also printed in order to avoid problems for those who are colour-blind.
- Narrow tongue design for limited space applications.



Product Classification

| | |
|--------------------|--|
| Item Number | 6009745 |
| Part Number | - |
| Detail Description | Copper Lug, AWG2/0#, one hole 5/16", with inspection window,Narrow,Black |

General Specifications

| | |
|-------------------|------------------------|
| Colour Code | Black |
| Material | Copper |
| Tongue Type | Narrow |
| Tongue Angle | Straight |
| Surface | Tin-plated |
| Inspection Window | With inspection window |

Dimensions

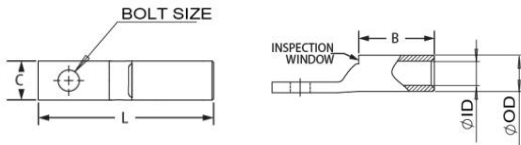

| | |
|---------------------|-------------------|
| Bolt Size | 5/16 in 8.4 mm |
| Tang Width (C) | 0.62 in 15.7 mm |
| Barrel length (B) | 0.93 in 23.5 mm |
| Overall length (L) | 2.06 in 52.5 mm |
| Inner diameter (ID) | 0.45 in 11.4 mm |
| Outer diameter (OD) | 0.56 in 14.3 mm |

Electrical Specifications

| | |
|--------------------------|------|
| Rating - Maximum Voltage | 35KV |
|--------------------------|------|

| | |
|--|--|
| Environmental Specifications | |
| Operating Temperature | -40 °C to +90°C (-40 °F to +212 °F) |
| Storage Temperature | -40 °C to +80 °C (-40 °F to +176 °F) |
| Packaging and Weights | |
| Included | Lug |
| Packaging Quantity and UOM | 1 pcs |
| Piece Weight | 0.116 lb 0.053 kg |
| Certifications and Certificated | |
| ISO 9001:2015 | Designed, manufactured and/or distributed under this quality management system |
| RoHS | Compliant |
| UL | Compliant |

