

EGG-SHAPED SNAP HOOK, 70mm, SS316

- Easy and quick installation
- Made of type 316 stainless steel for superior corrosion resistance, durability, and a compact yet high-load design.



Product Classification

Item Number	6009746
Part number	--
Detail Description	EGG-SHAPED SNAP HOOK, 70mm, SS316

General Specifications

Material	316 Stainless Steel
Size	70mm
WLL	300KG

Dimensions

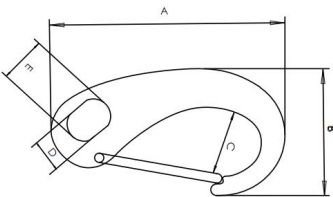

Dimension A	70mm
Dimension B	33mm
Dimension C	15.5mm
Dimension D	9.8mm
Dimension E	14.5mm

Packaging and Weights

Included	EGG-SHAPED SNAP HOOK, 70mm, SS316
Weight, Gross	0.054 kg  0.119lbs

Certifications and Compliance

ISO 9001:2015	Designed, manufactured and/or distributed under this quality management system
RoHS	Compliant

